

aluminium support system for
rain screen cladding panels

NVELOPE SYSTEM NV3

CONTENTS:

NV3-01	Tolerances for adjustment
NV3-02	Elevation of cladding – details
NV3-03	Elevation of cladding
NV3-04	Horizontal section – NVELOPE 90
NV3-05	Vertical section – NVELOPE 90 SINGLE
NV3-06	Vertical section – NVELOPE 90 DOUBLE
NV3-07	Vertical section with joint in profile
NV3-08	Vertical section – base detail
NV3-09	Vertical section – head of cladding
NV3-10	Horizontal section–external corner
NV3-11	Horizontal section–internal corner
NV3-12	Horizontal section–window jamb detail
NV3-13	Vertical section–window sill detail
NV3-14	Vertical section–window head detail
NV3-15	Final fix detail
NV3-16	Clips and rail detail

LEGEND:

A	–	Cladding SHEET
B	–	PTS Screw or Under cut anchor
C1	–	Secret fixing clip with levelling screw
C2	–	Secret fixing clip.
D	–	Screw
E	–	Fixing screw
F	–	Window profile
1	–	Steel frame wall
2	–	NVELOPE – support bracket
3	–	Primary Fixing
4	–	L profile vertical (60 X 40 X 2.2)
5	–	SR2 self drilling stainless steel screw
6	–	Horizontal Profile
7	–	Insulation
8	–	Ventilation
10	–	NVELOPE Isolator

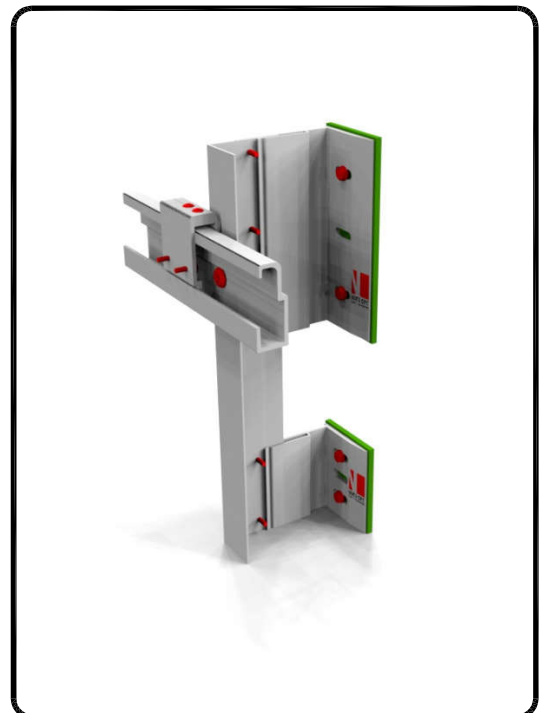
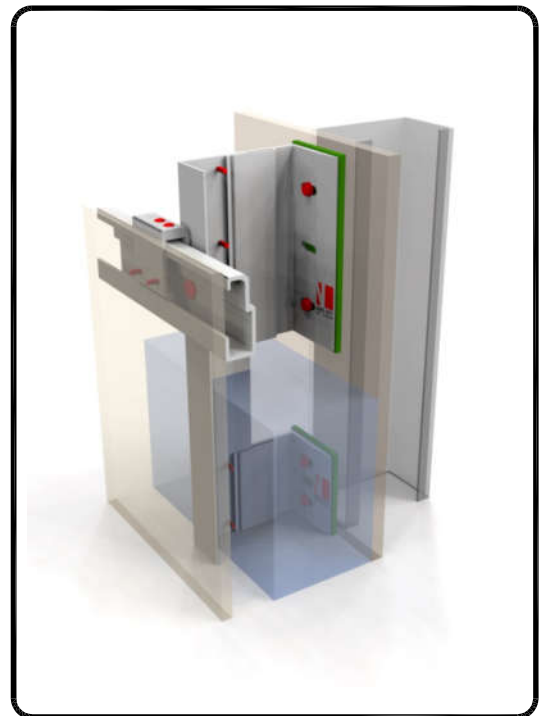

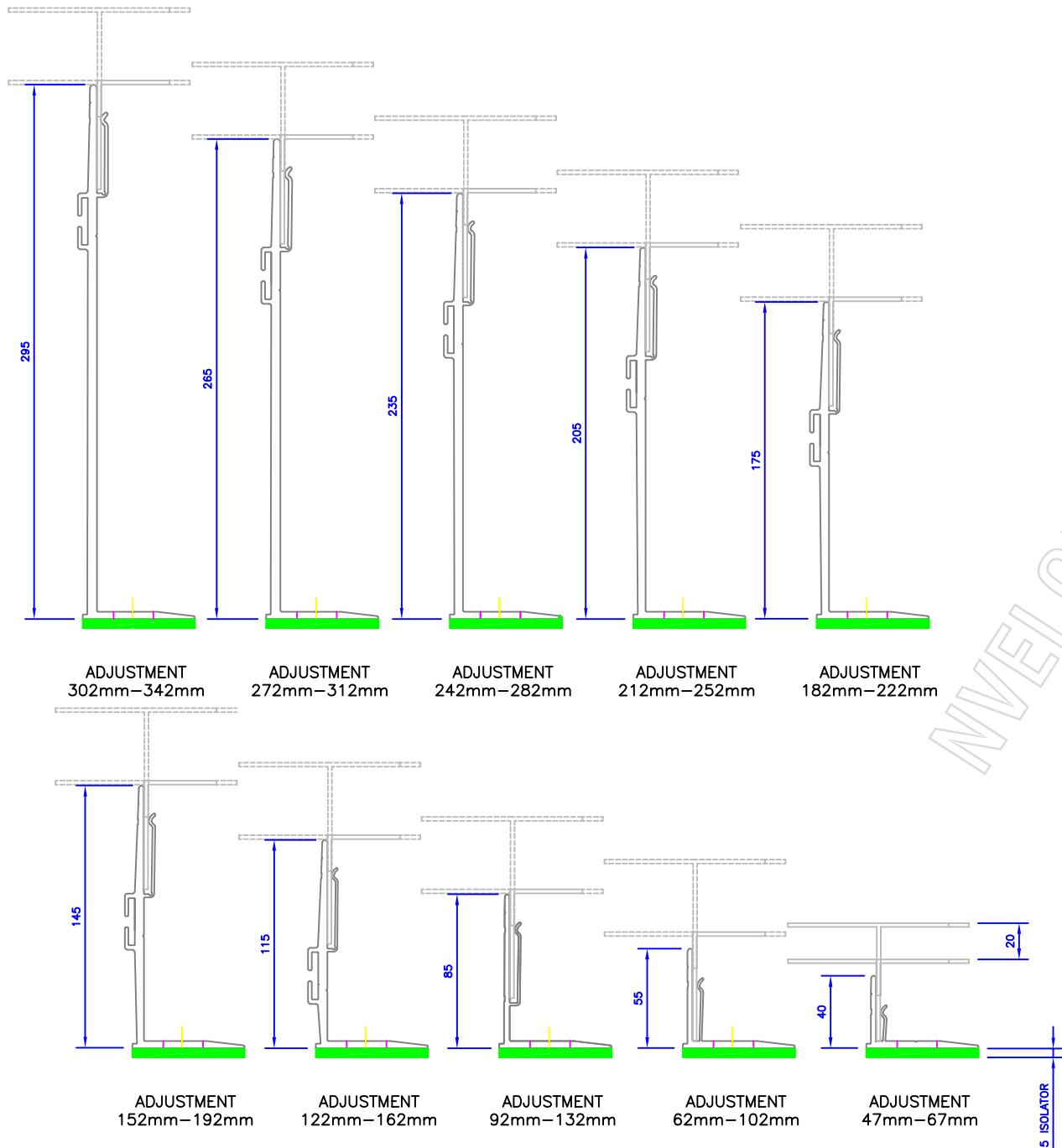

BRACKETS	Adjustment range for each bracket (mm)	
Nvelope 40	from 47	to 67
Nvelope 60	from 62	to 102
Nvelope 90	from 92	to 132
Nvelope 120	from 122	to 162
Nvelope 150	from 152	to 192
Nvelope 180	from 182	to 222
Nvelope 210	from 212	to 252
Nvelope 240	from 242	to 282
Nvelope 270	from 272	to 312
Nvelope 300	from 302	to 342

HORIZONTAL SECTIONS
TOLERANCES FOR ADJUSTMENT

Detail Sheet :- system NV3 - 01

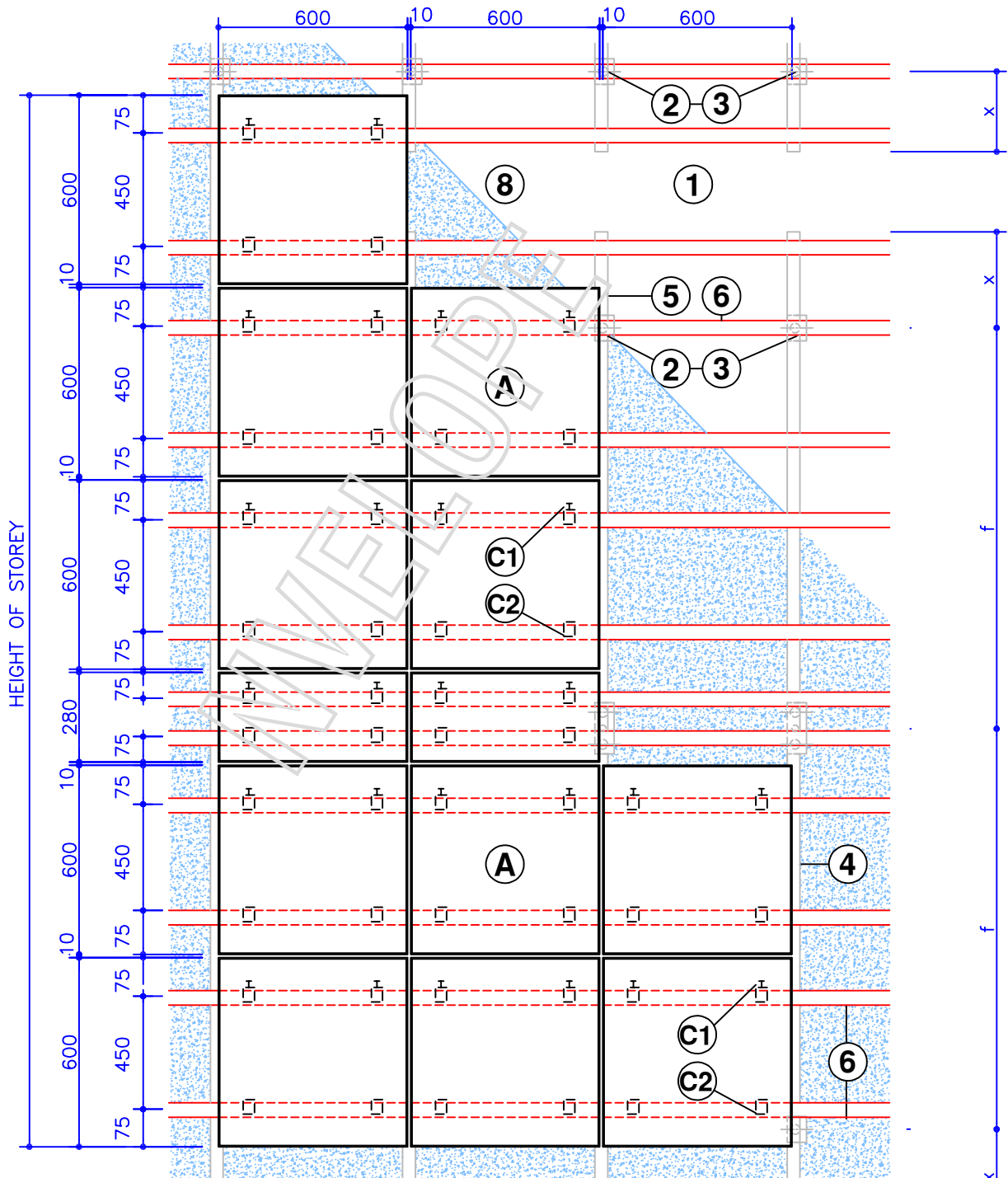

PANEL MODULE 60 x 60 or 60 x 30
ELEVATION OF CLADDING

Technical drawing of a three-story building facade showing window and door layouts. The drawing includes dimensions and labels for various components.

Dimensions (mm):

- Overall Width:** 600
- Overall Height:** 1000 (75 + 450 + 280 + 75)
- Window Widths:** 75, 450, 75
- Window Heights:** 75, 450, 280
- Door Width:** 600
- Door Height:** 280
- Vertical Spacing:** 75, 450, 280, 75
- Horizontal Spacing:** 75, 450, 75

Labels and Callouts:

- A:** Labels for the three main window units.
- C1:** Labels for the top and bottom window units.
- C2:** Labels for the middle window unit.
- 1, 2, 3, 4, 5, 6:** Labels for the door and window components.

The drawing shows a three-story building facade with a central door and two side windows. The dimensions are provided in millimeters. The labels A, C1, C2, and 1 through 6 identify the various components of the facade.



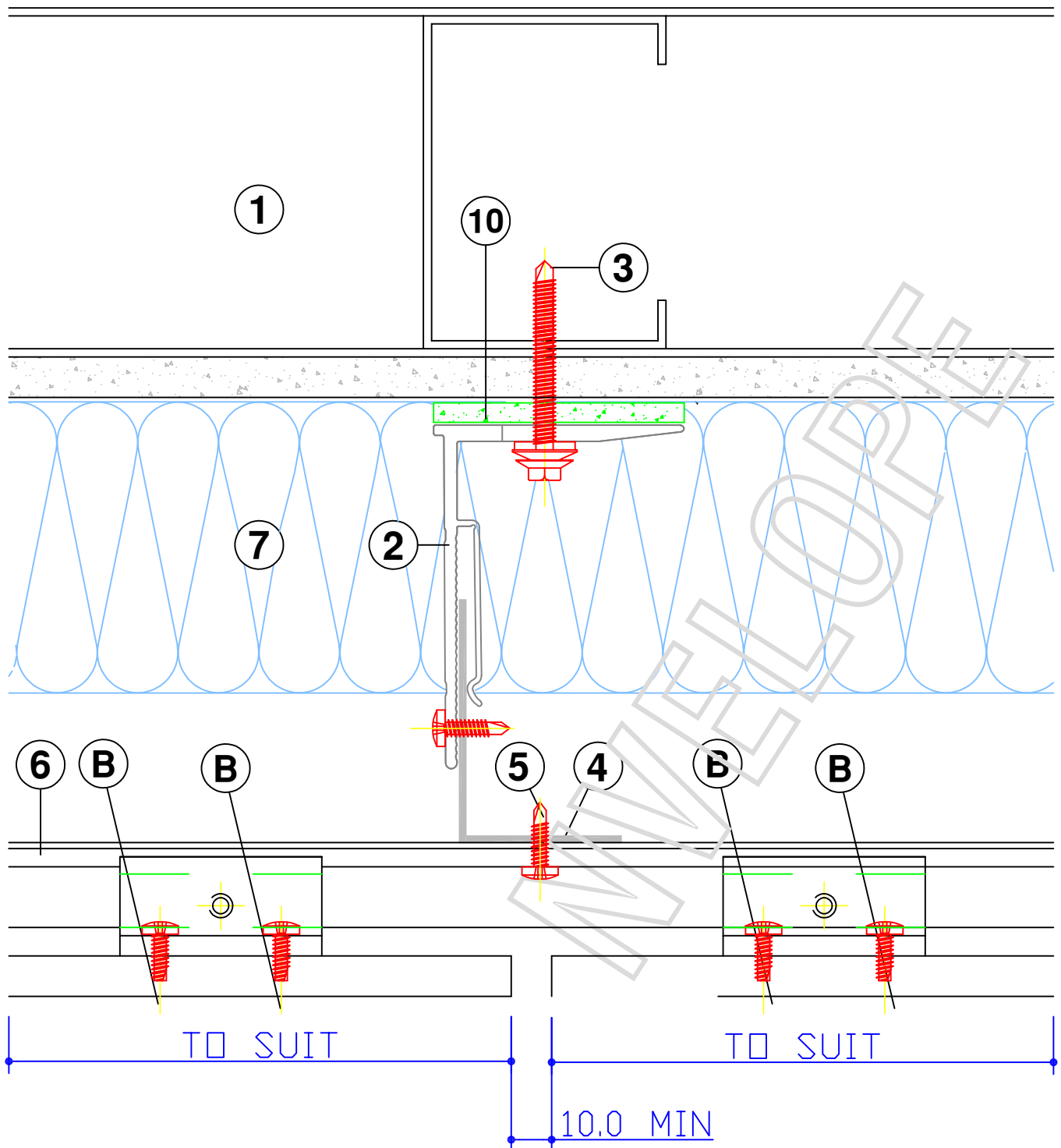

HORIZONTAL SECTION - NVELOPE 90



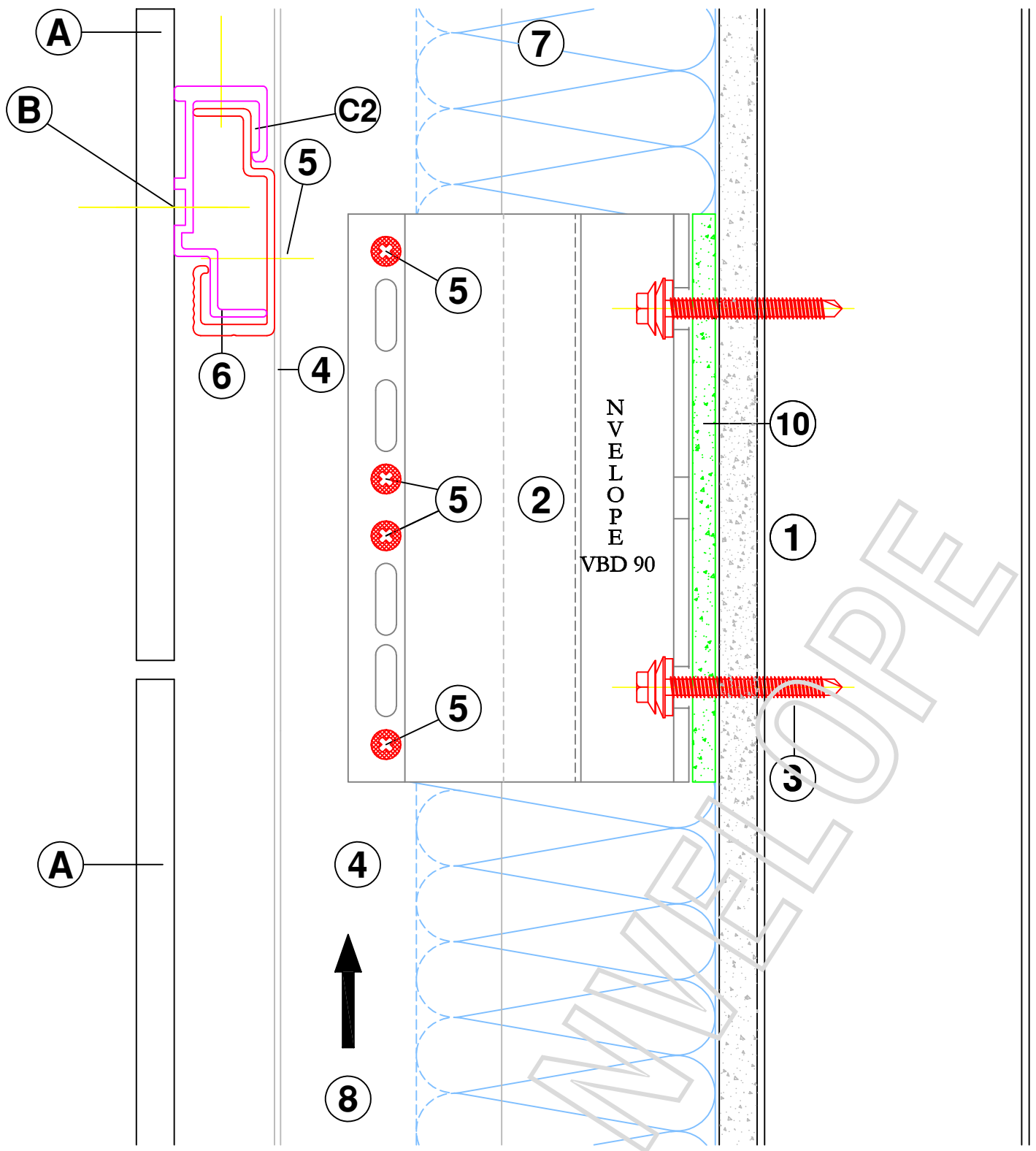

VERTICAL SECTION - NVELOPE DOUBLE

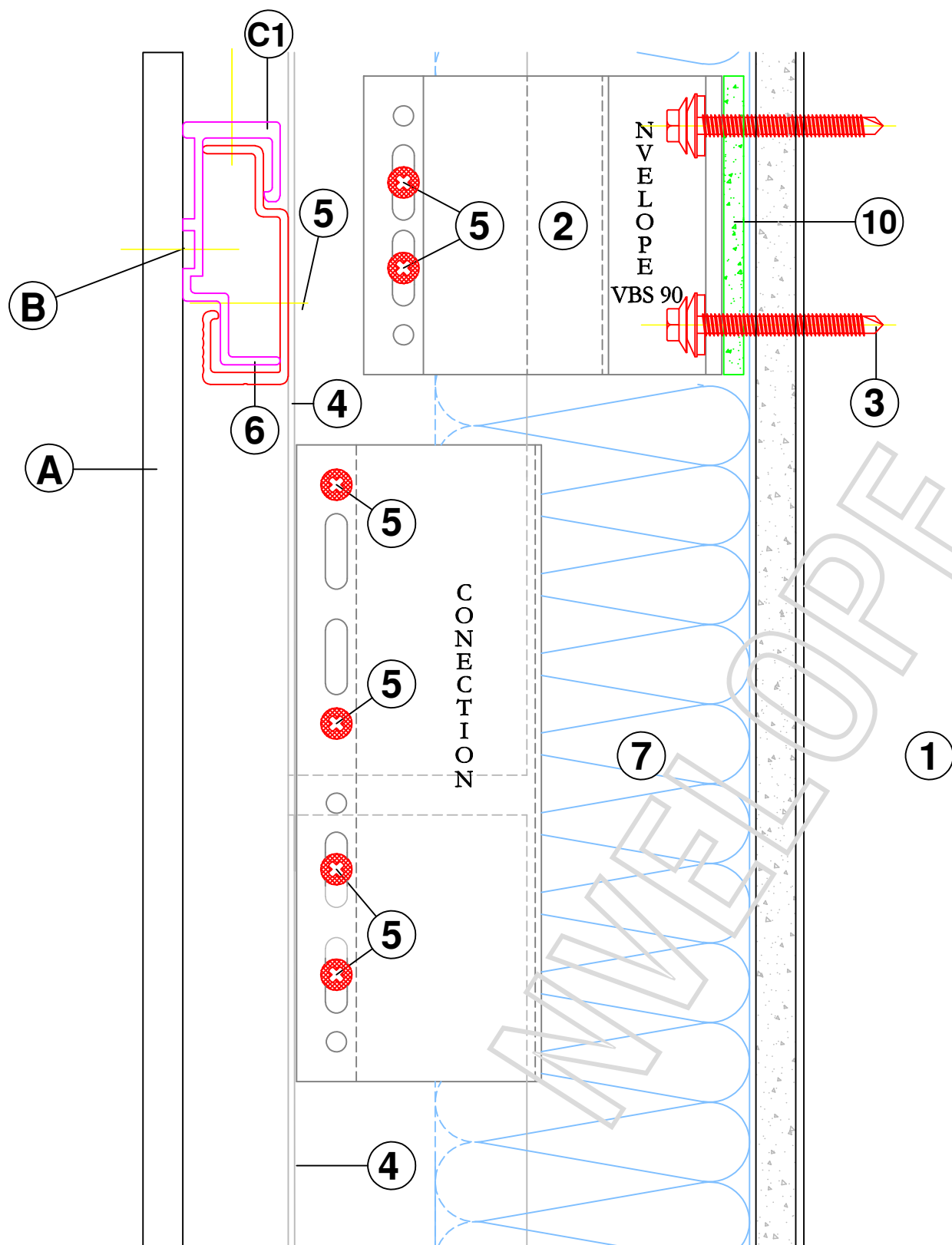

VERTICAL SECTION - CONNECTION PIECE - JOINING OF PROFILES

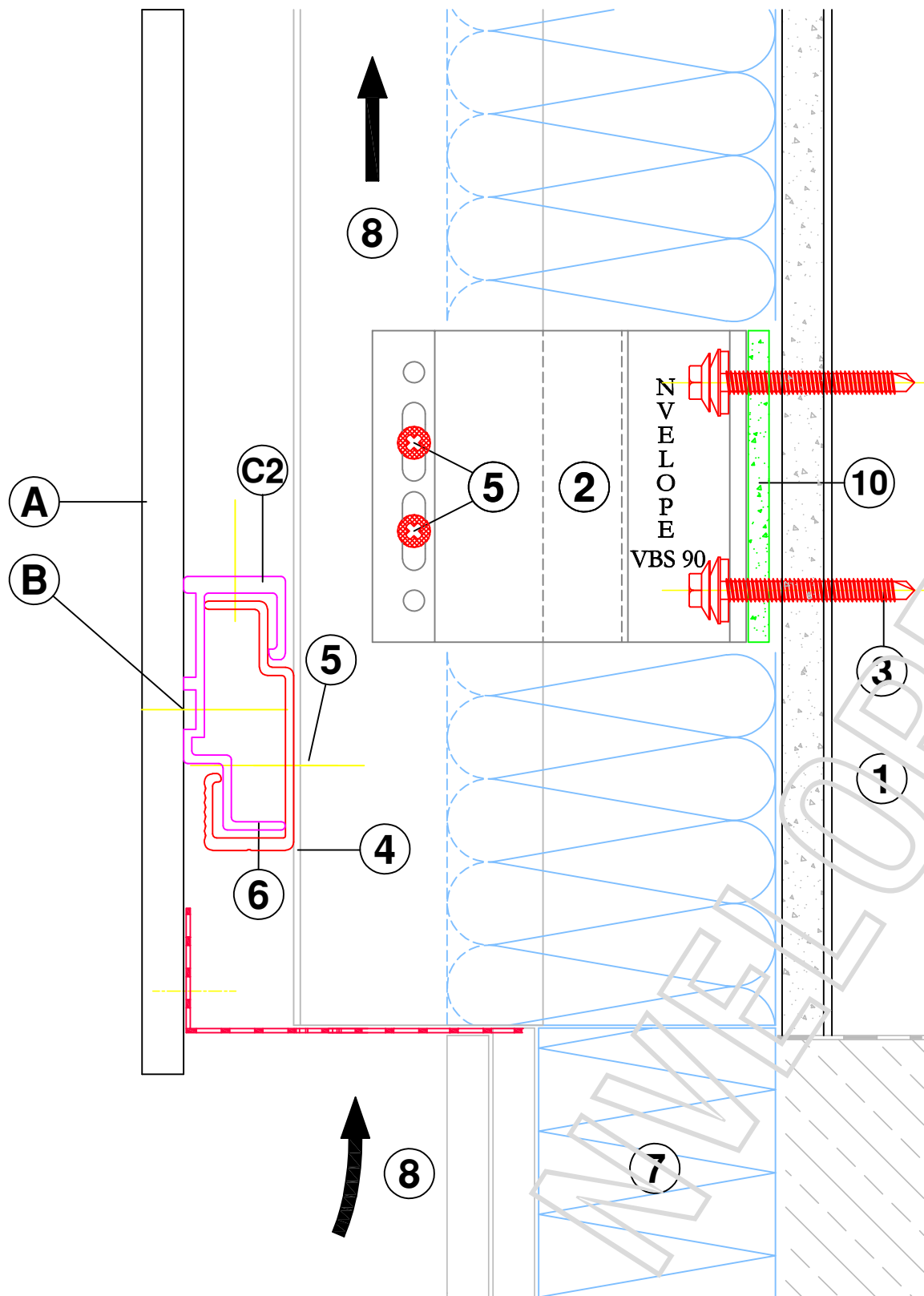

VERTICAL SECTION - BASE OF CLADDING

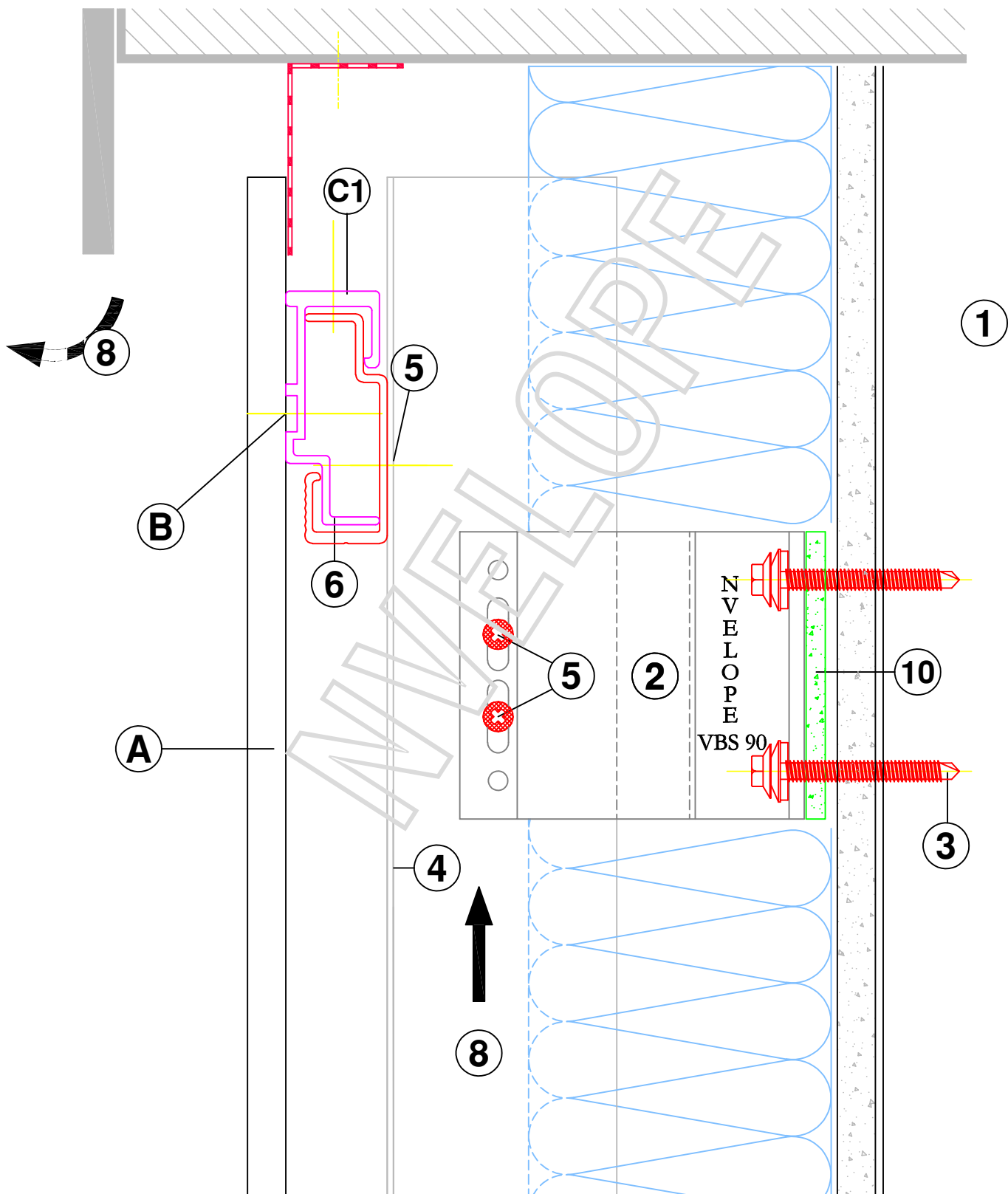

VERTICAL SECTION - HEAD OF CLADDING

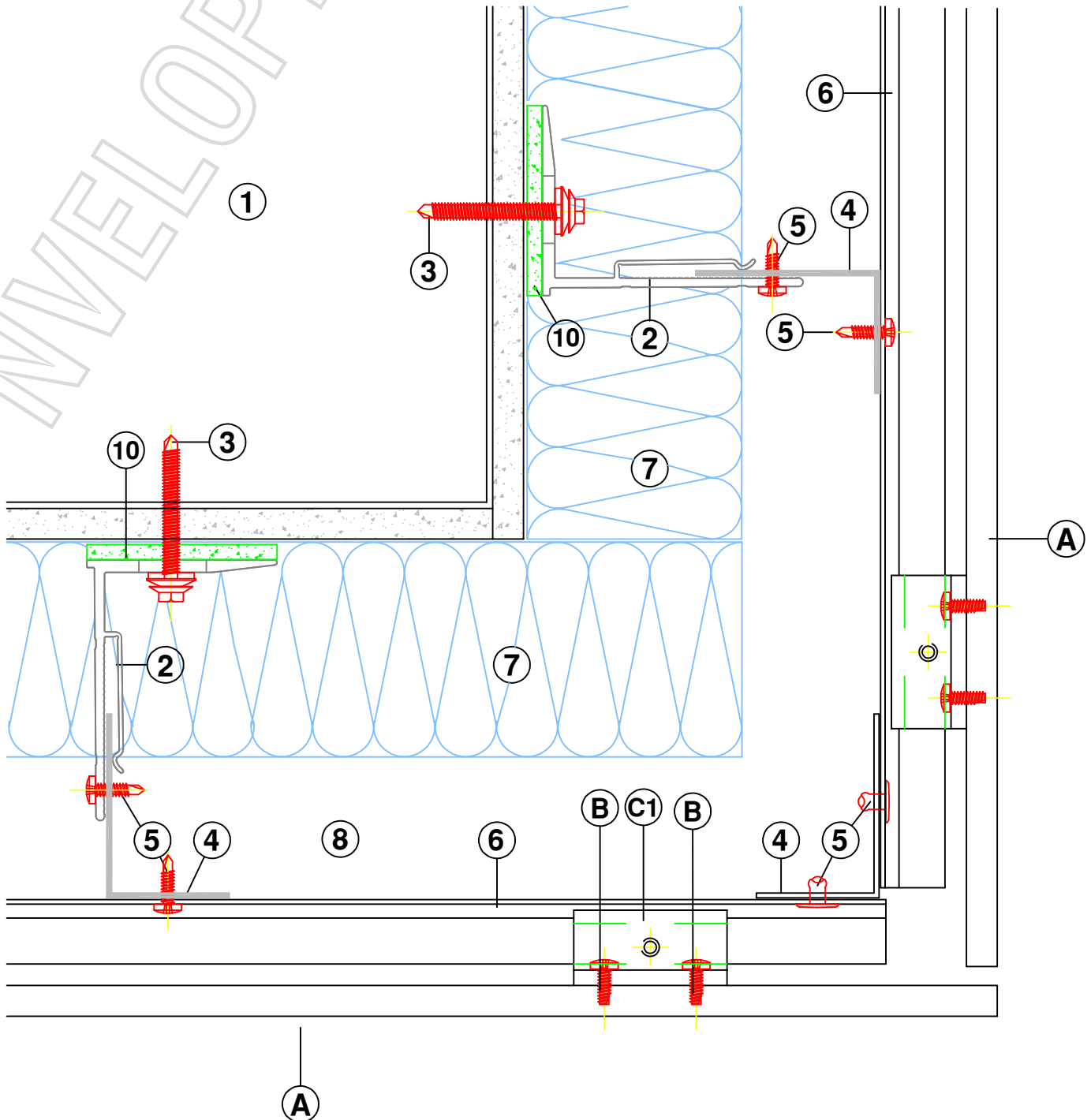

HORIZONTAL SECTION - EXTERNAL CORNER

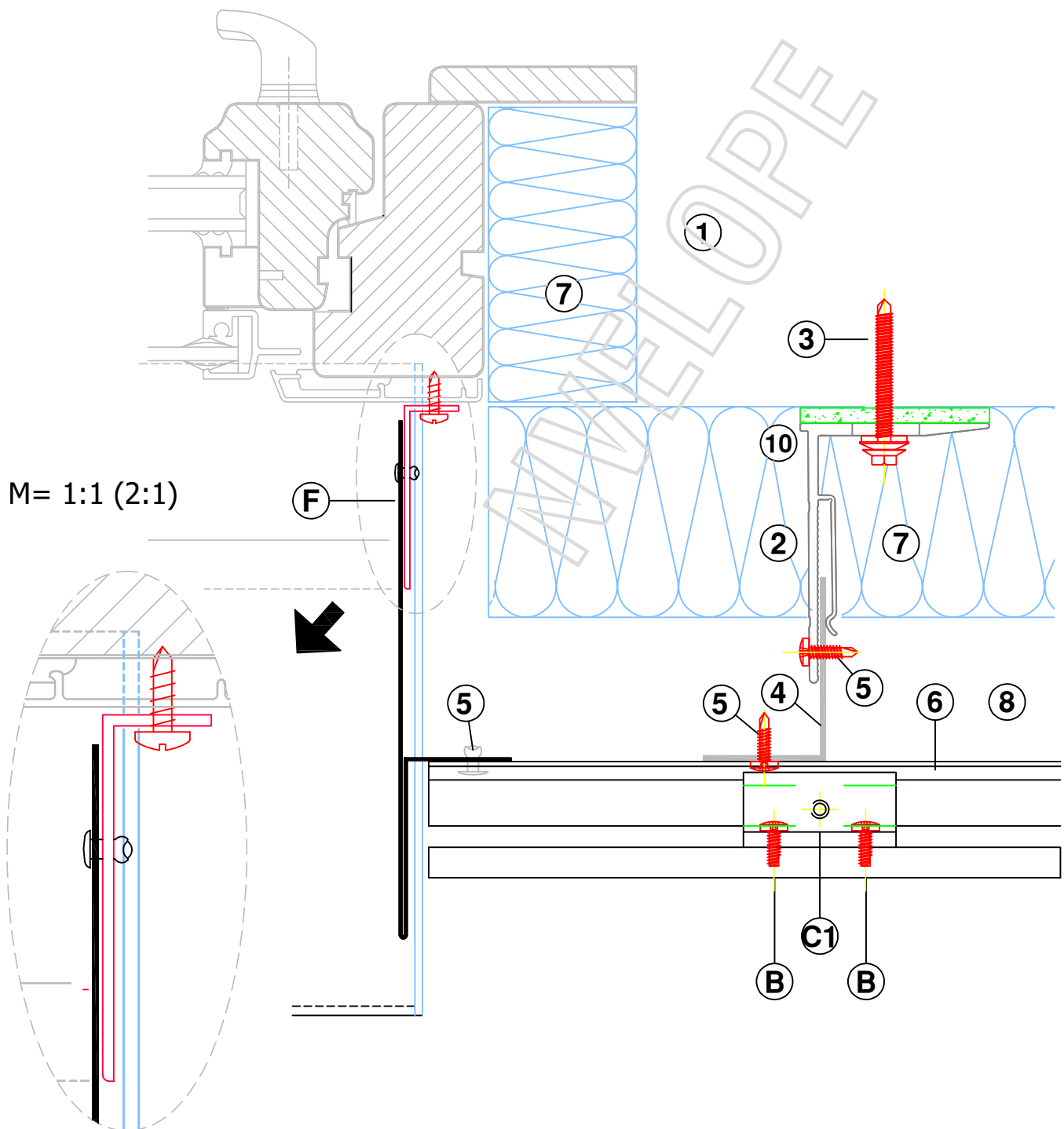

HORIZONTAL SECTION - WINDOW JAMB DETAIL

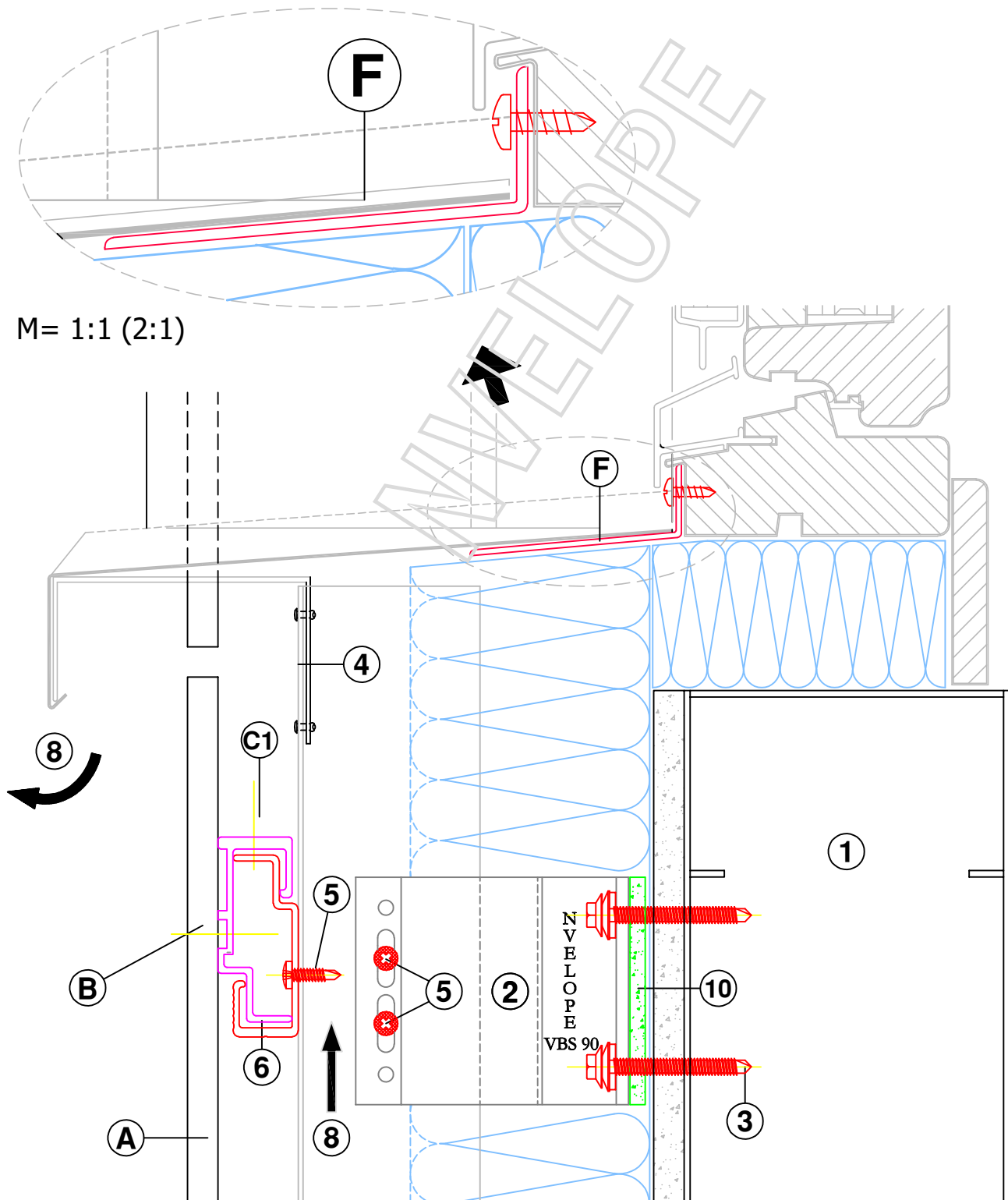

VERTICAL SECTION - WINDOW SILL DETAIL

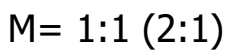

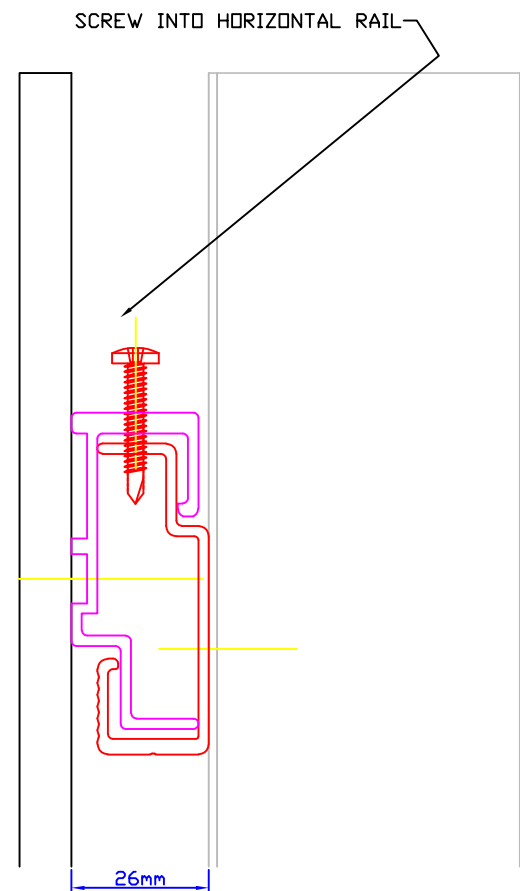
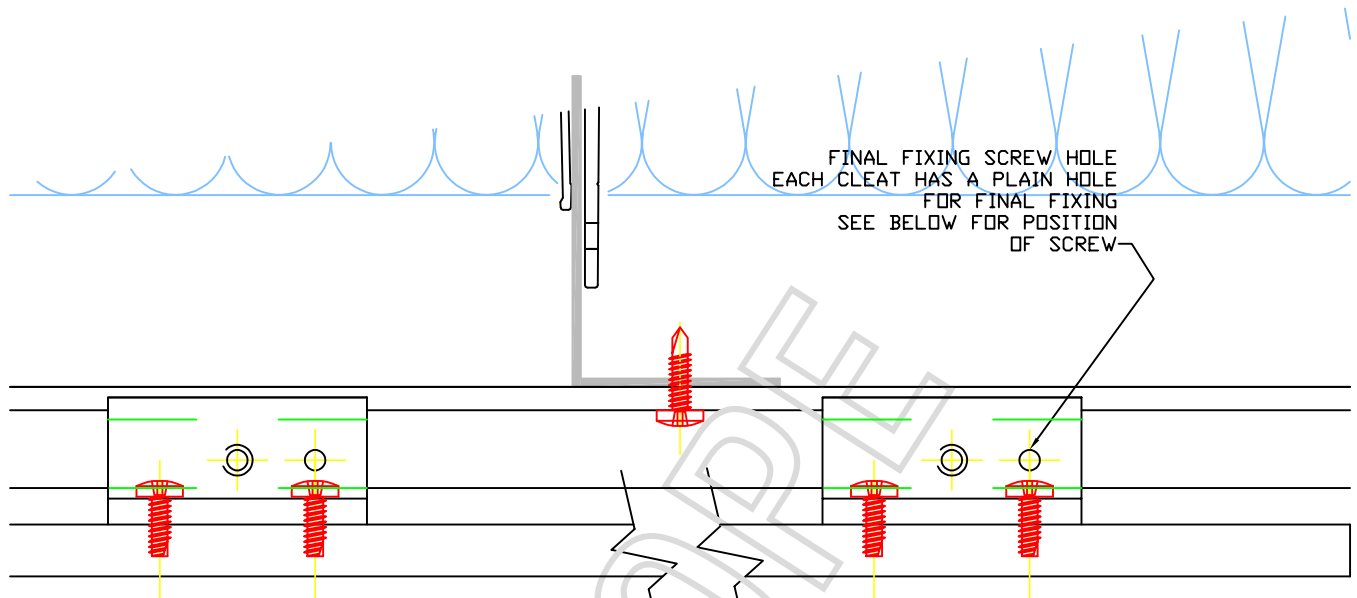

FINAL FIXING SCREW

Detail Sheet :- NV3 - 15

nvelope.com.au

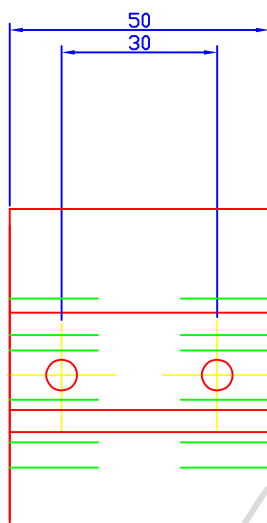
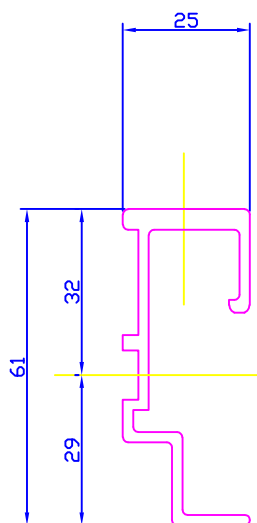

NV3 CLIP

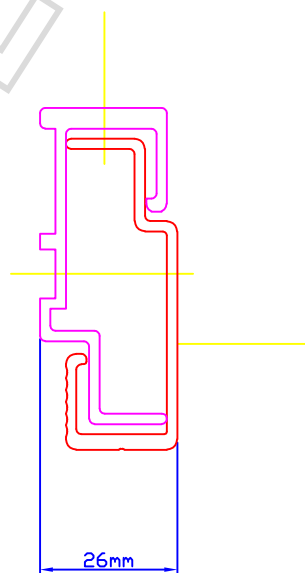
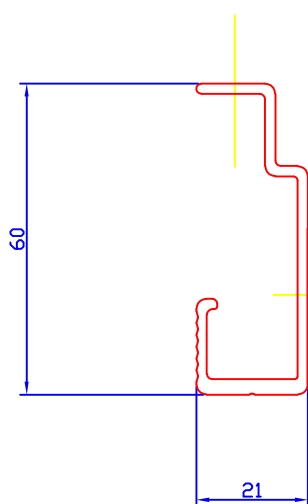

NV3 RAILS

ASSEMBLY DIM

NV3 PTS HANGER

Detail Sheet :- NV3 - 16

nvelope.com.au