



SPECIFICATION TEMPLATE

SELEKTA Timber Composite Cladding

1. SCOPE OF WORK

The scope of work includes the design, supply, fabrication and installation SELEKTA Timber Composite Cladding, complete with all necessary sub-structures, anchors, hardware and fittings to provide a total installation and cladding system from the structure out.

2. MATERIAL AND FINISHES

Cladding Material:

The cladding shall be SELEKTA Timber Composite Cladding supplied by Blue Chip Group Pty Ltd (Ph: 1300 945 123) consisting of a particle wood core of processed timber exclusively from untreated pulpwood in the form of wood shavings, thinning material and round timber from sustainable, domestic forestry. Timber from tropical climates shall not be used. The binding agent used is a thermosetting artificial resin with building authority approval for outdoor use and as a wood preservative, we use an eco-friendly boron-based product with building authority approval that does not contain lindane or PCP. A mixture of boric acid and borax is used as a fire protection agent and no isocyanates, phosphates or halogens are added.

****NO ALTERNATIVE MATERIALS WILL BE ACCEPTED FOR THIS PROJECT****

Colour Selection:

Refer to exterior finishes schedule.

(Select colour code/s from the 'Colour Chart' tab at the below link)

<http://www.bluechipgroup.net.au/timber-cladding-perth/timber-composite-cladding-perth.html>

Fire Properties:

Manufactured by Blue Chip Group Pty Ltd; SELEKTA Timber Composite Cladding is not non-combustible however it is compliant for type C construction and single dwelling residential projects up to Bushfire Attack Level BAL29. **For buildings in BAL 40 or BAL FZ and type A & B construction buildings which require cladding to be non-combustible, we recommend specifying ULTRAWOOD which is available in the same colours as SELEKTA. [Click here for details](#)**

SELEKTA Fire Performance Properties			
TEST STANDARD	RESULT		
BAL Rating	Up to BAL29		
AS 3837	Group Rating 3		
AS1530.3	PASS	Ignitability Index	13
	PASS	Heat Evolved	0
	PASS	Spread of Flame	4
	PASS	Smoke Developed	3

Applied Finish:

Several layers of paper are impregnated with artificial resins for use as a coating, similar to high pressure exterior laminate. The surface and core are fused together without seams in a single process under the application of high pressure and heat. The surface is printed or dyed and a transparent weather resistant surface coating is applied on the decor side followed by coloured surface coating using a pure, water-based acrylate. The pigments added are free of toxic heavy metals (no lead, chrome or cadmium). The rear side is brown or milky white from the production process and offers no colour options.



Physical Properties:

ITEM	TEST STANDARD	UNIT	RESULT
Material Density	Actual	Kg/m ³	800-950
Flexural Strength	EN 310 / EN 438	N/mm ²	40-45
Elasticity Modulus	EN 310 / EN 438	N/mm ²	4-6
Transverse Tensile Strength	EN 319	N/mm ²	2-3
Moisture Content	EN 322	%	5-10
Swelling After Storage in Water <ul style="list-style-type: none"> ▪ At 20°C After 2hrs ▪ At 20°C After 24hrs 	DIN 317 DIN 317	% %	0.3-0.6 3-5
Thermal Expansion	Actual	mm/m	1-3
Thermal Conductivity	DIN 52 612	W/mk	0.20
Water Vapour Permeability	DIN 52 615	M	5-15
Scratch Resistance	EN 438	N	0.5-1.5
Light Fastness	DIN 54 004	-	Level 8
Chemical Resistance	EN 438	-	Limited
Colour Deviation	DIN 5033	Delta E	<1

3. FABRICATION

Technical Manual:

The panels shall be fabricated and installed in accordance with the most recent version of the SELEKTA Technical Manual which is available online at www.bluechipgroup.net.au or by emailing sales@bluechipgroup.net.au or by calling **1300 945 123**.

Warranty:

SELEKTA shall be covered by a manufacturer's warranty for a minimum period of 10 years. All work to be carried out in accordance with the manufacturer's recommendations and installation details. The warranty is subject to the cladding system being fabricated and installed by a manufacturer trained and approved installer with a minimum 5 years' experience.

4. INSTALLATION

Installation Details:

The panels shall be fabricated and installed in accordance with the most recent version of the SELEKTA Installation Details which are available online at www.bluechipgroup.net.au or by emailing sales@bluechipgroup.net.au or by calling **1300 945 123**. (Only PDF installation details are available online. For CAD/DWG installation details email or call as above).

General Guidelines:

The cladding system shall be installed using secret-fix screws to STUDTEK steel top-hats or timber framing over AS 4200.1 compliant sarking which has been installed as per AS 4200.2 to satisfy the deemed-to-satisfy (DTS) weatherproofing requirements in accordance with NCC 2022, clause F3D3. Use CLADTRIM colour-matched trims supplied by Blue Chip Group Pty Ltd or custom trims and flashings, supplied by others, for all junctions and joint details, sealed with PROLASTIK sealant as required to ensure weatherproofing.

All work to be carried out in accordance with the SELEKTA manufacturer's recommendations and installation manuals. All component parts shall be installed level, true to line with uniform joints and reveals.



5. SYSTEM COMPONENTS

Insulated Façade System - OPTIONAL:

For an optional insulated façade system use BICEP façade brackets and support profiles with IROCK non-combustible insulation to achieve an engineered exterior insulation zone.



Sarking:

In climate zones 1-3, sarking shall be FIRESPAN DTS non-combustible vapour barrier and in climate zones 4-8, sarking shall be FIRESPAN Class 4 vapour permeable membrane, as per the requirements of NCC 2022 clause F8D3. Install and tape sarking in accordance with AS 4200.2 behind all cladding areas for DTS weatherproofing compliance as per NCC 2022 clause F3D3.

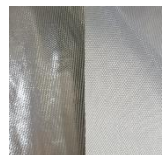

Sub-framing System:

The sub-framing system shall be structural timber or STUDTEK steel top-hats attached to the main structure (or BICEP Façade System) in a manner to ensure all applied loadings to the cladding is transferred back to the main structure. Size and spacing of top hat members shall be determined according to applied loads and deflection limitations for any given project. Top-hat centres shall be maximum 600mm centres unless otherwise approved by a structural engineer.



Colour-matched Trim Profiles:

Shall be CLADTRIM aluminium trims supplied by Blue Chip Group Pty Ltd and colour-matched to the selected cladding finish. Install and seal with PROLASTIK sealant in accordance with manufacturer's recommendations to ensure weatherproofing.

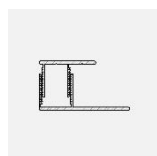
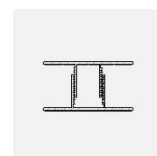
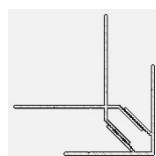
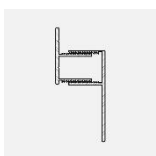
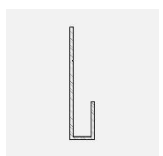
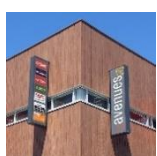



Joint & Trim Sealant:

All penetrations and junctions shall be sealed with PROLASTIK matt NC silicone sealant supplied by Blue Chip Group Pty Ltd and installed over closed cell foam backing rod, as applicable, to manufacturer's specifications and as required for weather-proofing compliance.



Fixings:

Fasteners, including concealed screws, nuts, bolts, and other items required for connecting aluminium to aluminium or aluminium to steel shall be in accordance with AS 3566.2 and of a type to suit its application and exposure conditions.

- Class 1/2: Internal applications.
- Class 3: External applications, moderate industrial and marine applications.
- Class 4: Severe marine applications

Dissimilar Materials:

Where two surfaces of dissimilar material come into contact, such surfaces shall be separated with a layer of PVC or Polyethylene tape, or powder-coat finish as required to ensure against bimetallic corrosion.